

Tanz Neuroscience Building  
6 Queen's Park Crescent W

Building code: TZ



Photo 1 - Building

Photo 2 - Main Entrance

Photo 3 - Accessible Entrance at rear

Number of Building entrances	3
Number of Entrances with Power Openers	1
Floors accessible via elevator	all
Floors with accessible washrooms	B

Main Entrance

Side of building with main entrance	North East
Does this entrance have a power door opener?	No
Is this entrance visible from the street?	Yes
Type of Pathway leading to entrance	Stair

Secondary Entrance

Side of building with secondary entrance	West
Does this entrance have a power door opener?	Yes
Is this entrance visible from the street?	No
Type of Pathway leading to entrance	

There is an accessible entrance with ramp located just off of the courtyard on the south west corner of the building, behind the Leslie L. Dan Pharmacy Building.

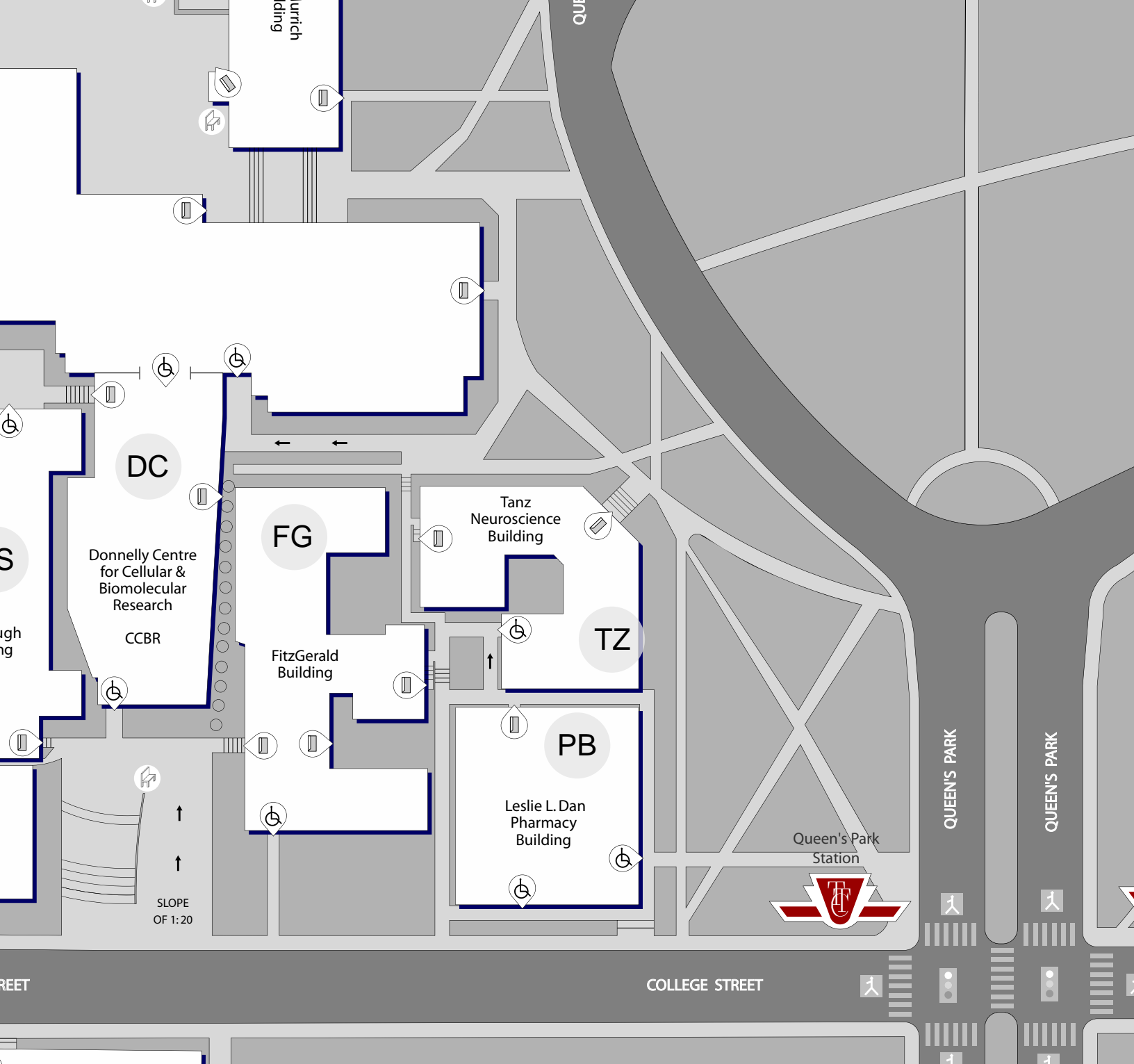

Entrance  
 Entrance with Auto Door Opener  
 Sidewalk  
 Ramp: arrow indicates up  
 Stair  
 Rest Area



Vehicle Traffic Lights  
 Stop Signs  
 Pedestrian Crossing Lines  
 Flashing Pedestrian Signal  
 Button for Pedestrian Crossing  
 Audio Crossing Signal



Parking  
 Reserved Parking



North