

Leslie L. Dan Pharmacy Building
144 College Street

Building code: PB



Photo 1 - Building

Photo 2 - Accessible Main Entrance on East Side

Number of Building entrances	3
Number of Entrances with Power Openers	2
Floors accessible via elevator	all
Floors with accessible washrooms	b1, b2, 2, 4, 6, 9, 10, 11

Main Entrance

Side of building with main entrance	East
Does this entrance have a power door opener?	Yes
Is this entrance visible from the street?	Yes
Type of Pathway leading to entrance	Path

Secondary Entrance

Side of building with secondary entrance	South
Does this entrance have a power door opener?	Yes
Is this entrance visible from the street?	Yes
Type of Pathway leading to entrance	Path

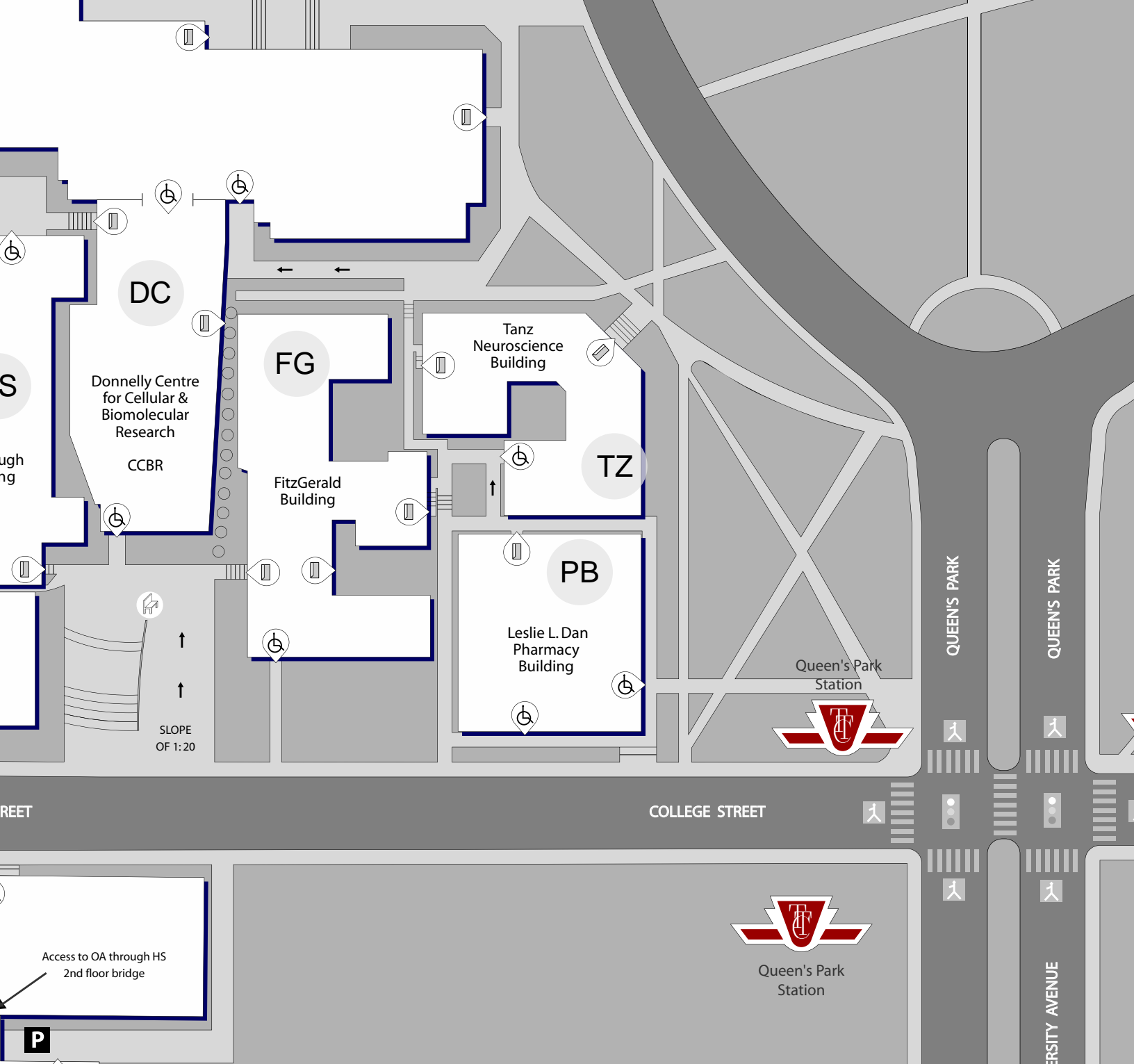

 Entrance

 Entrance with Auto Door Opener

 Sidewalk

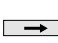
 Ramp: arrow indicates up

 Stair

 Rest Area

 Vehicle Traffic Lights

 Stop Signs

 Pedestrian Crossing Lines

 Flashing Pedestrian Signal

 Button for Pedestrian Crossing

 Audio Crossing Signal

 Parking

 Reserved Parking



North