

Health Sciences Building
155 College Street

Building code: HS



Photo 1 - Building

Photo 2 - Main Entrance Stair and Ramp

Number of Building entrances	1
Number of Entrances with Power Openers	1
Floors accessible via elevator	all
Floors with accessible washrooms	none

Main Entrance

Side of building with main entrance	North
Does this entrance have a power door opener?	Yes
Is this entrance visible from the street?	Yes
Type of Pathway leading to entrance	

Secondary Entrance

Side of building with secondary entrance	n/a
Does this entrance have a power door opener?	n/a
Is this entrance visible from the street?	n/a
Type of Pathway leading to entrance	

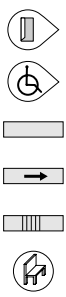
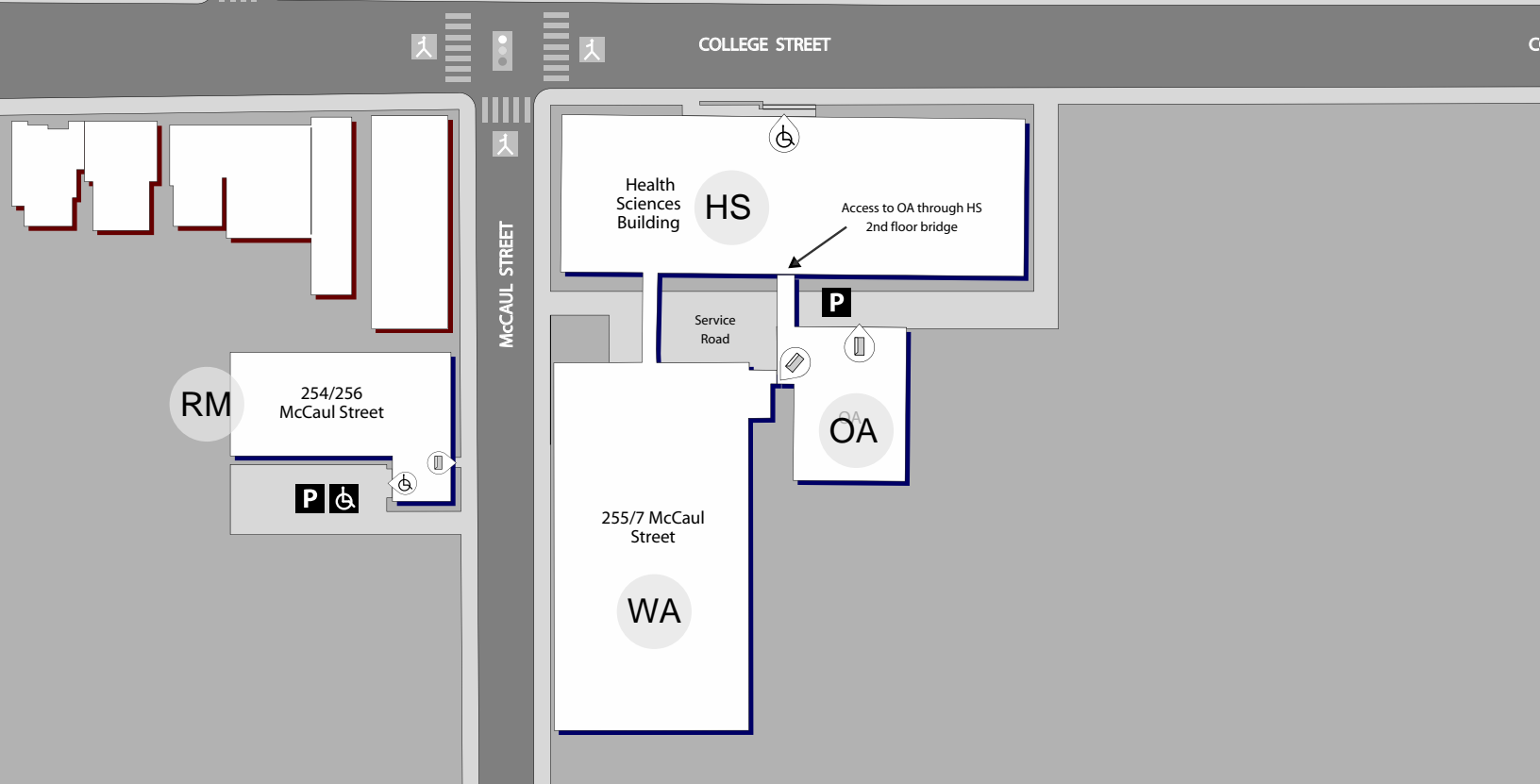
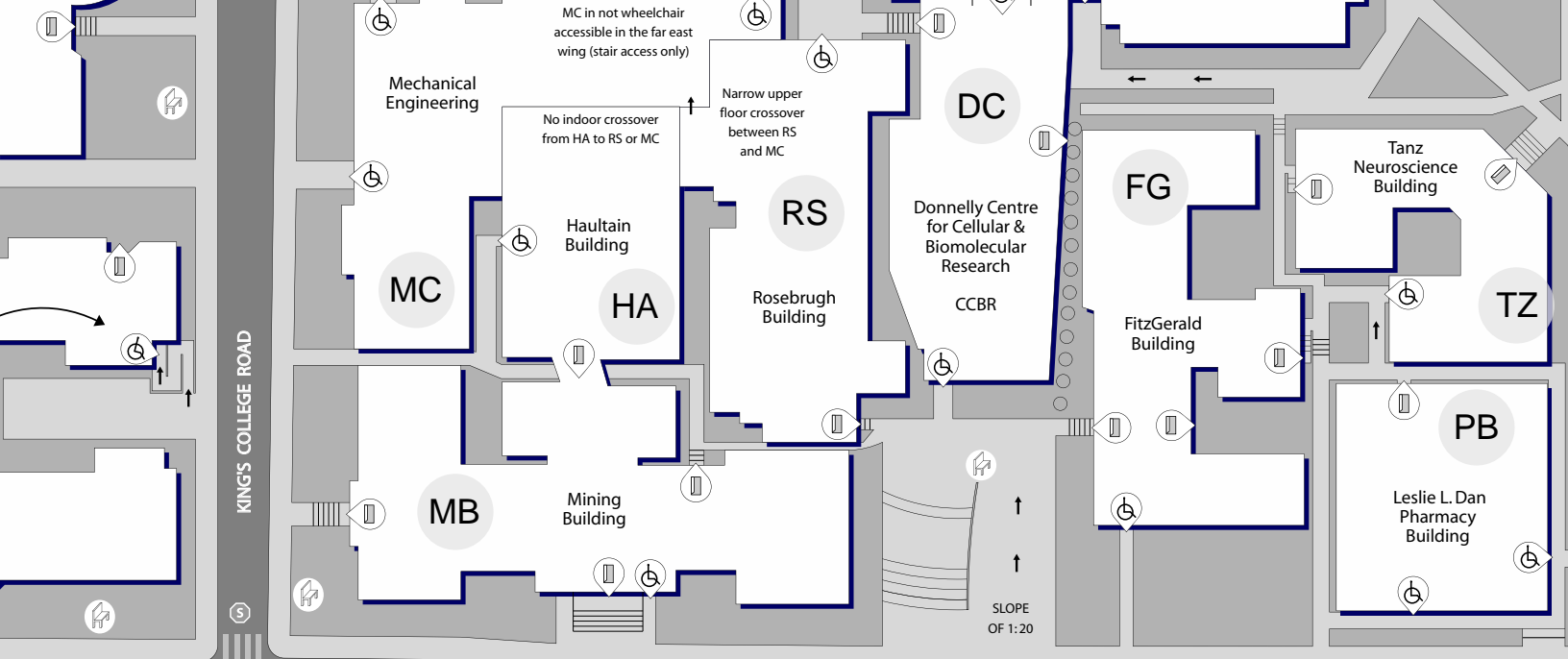

Entrance

Entrance with Auto Door Opener

Sidewalk

Ramp: arrow indicates up

Stair

Rest Area



Vehicle Traffic Lights

Stop Signs

Pedestrian Crossing Lines

Flashing Pedestrian Signal

Button for Pedestrian Crossing

Audio Crossing Signal



Parking

Reserved Parking



North