

Galbraith Building
35 St. George Street

Building code: GB



Photo 1 - Building

Photo 2 - Main Entrance Double Stair

Photo 3 - Accessible Entrance on North Side

Number of Building entrances	3
Number of Entrances with Power Openers	1
Floors accessible via elevator	4
Floors with accessible washrooms	0

Main Entrance

Side of building with main entrance	West
Does this entrance have a power door opener?	No
Is this entrance visible from the street?	Yes
Type of Pathway leading to entrance	Stair

Secondary Entrance

Side of building with secondary entrance	North
Does this entrance have a power door opener?	Yes
Is this entrance visible from the street?	Yes
Type of Pathway leading to entrance	Ramp

The accessible entrance to Galbraith is through the Sandford Fleming Building, located on the north side near where these two buildings join.

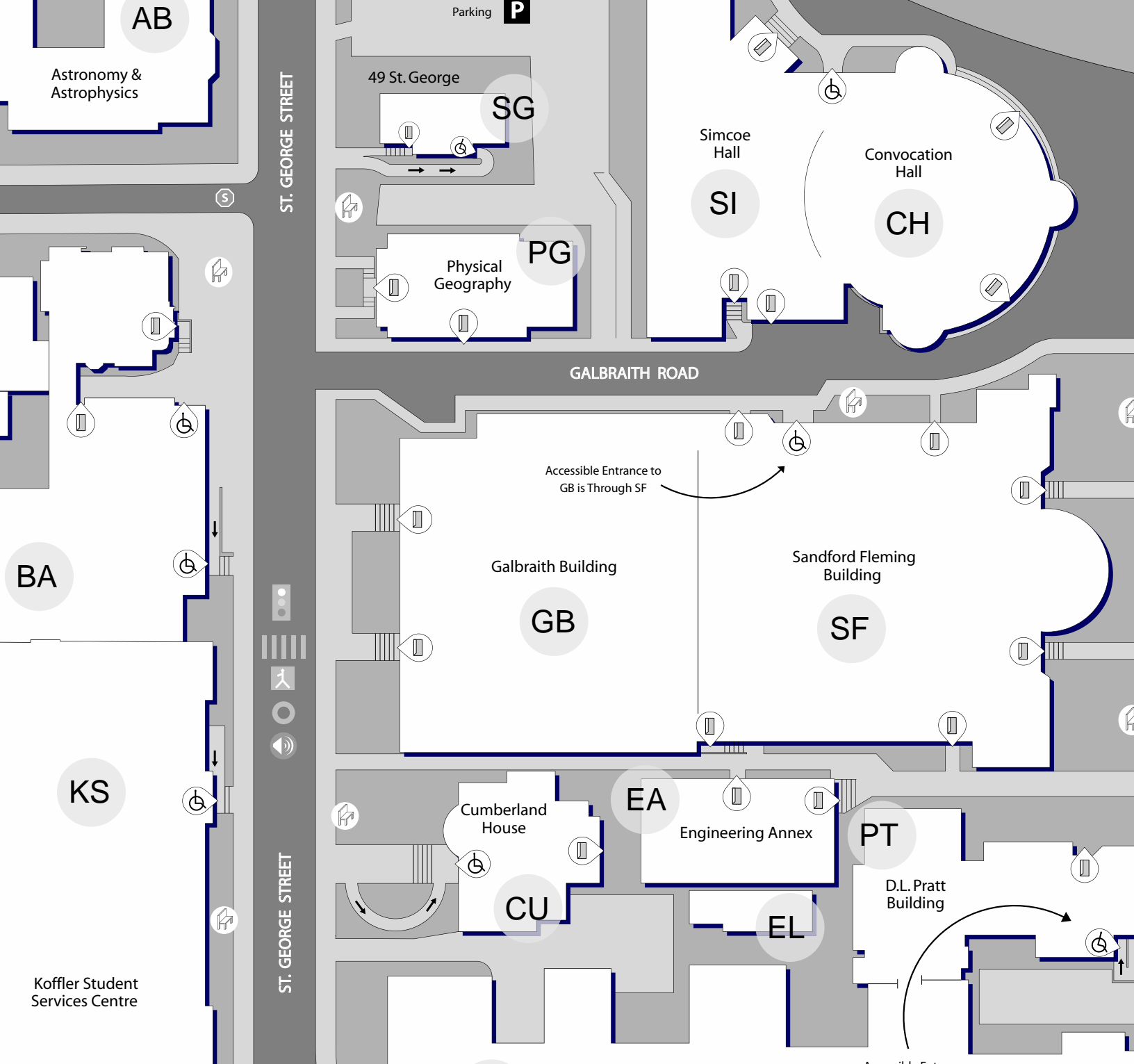

- | | | | | | |
|--|--------------------------------|--|--------------------------------|--|------------------|
| | Entrance | | Vehicle Traffic Lights | | Parking |
| | Entrance with Auto Door Opener | | Stop Signs | | Reserved Parking |
| | Sidewalk | | Pedestrian Crossing Lines | | |
| | Ramp: arrow indicates up | | Flashing Pedestrian Signal | | |
| | Stair | | Button for Pedestrian Crossing | | |
| | Rest Area | | Audio Crossing Signal | | North |